

REVISION HISTORY

REV.	DISCRIPTION	DATE	APP'D
A	DRAWING ORIGINATION	02/11/09	PC

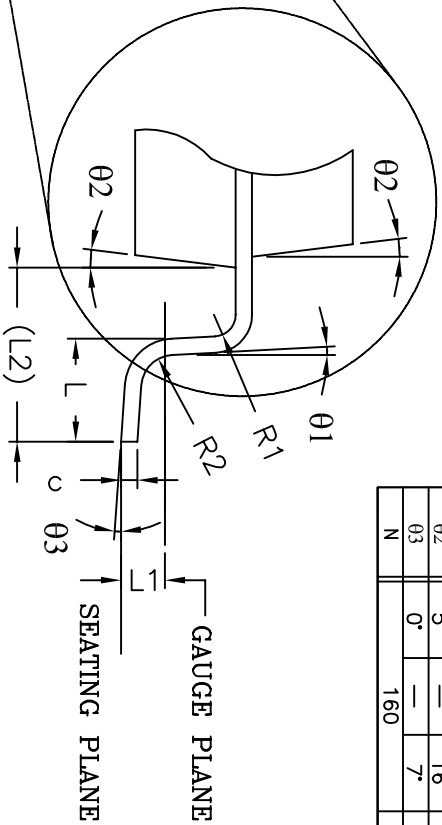
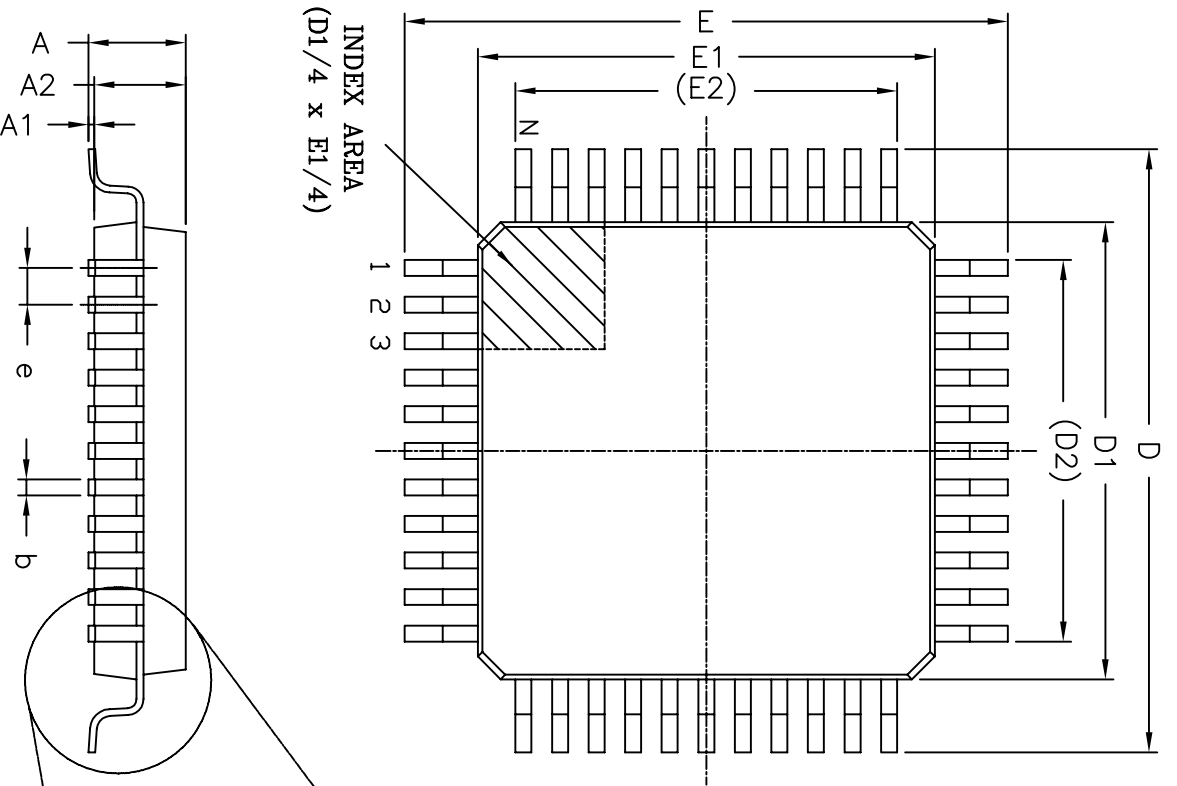

160 Pin MQFP JEDEC MS-022 Variation DD-1

SYMBOLS	DIMENSIONS IN MM (Control Unit)			DIMENSIONS IN INCH (Reference Unit)		
	MIN	NOM	MAX	MIN	NOM	MAX
A	—	—	4.10	—	—	0.161
A1	0.25	—	0.50	0.010	—	0.020
A2	3.20	3.40	3.60	0.126	0.134	0.142
b	0.22	—	0.40	0.009	—	0.016
c	0.11	—	0.23	0.004	—	0.009
D	—	31.20 BSC	—	—	1.228 BSC	—
D1	—	28.00 BSC	—	—	1.102 BSC	—
D2	—	25.35 REF	—	—	0.998 REF	—
E	—	31.20 BSC	—	—	1.228 BSC	—
E1	—	28.00 BSC	—	—	1.102 BSC	—
E2	—	25.35 REF	—	—	0.998 REF	—
e	—	0.65 BSC	—	—	0.026 BSC	—
L	0.73	0.88	1.03	0.029	0.035	0.041
L1	—	0.25 BSC	—	—	0.010 BSC	—
L2	—	1.60 REF	—	—	0.063 REF	—
R1	0.13	—	—	0.005	—	—
R2	0.13	—	0.30	0.005	—	0.012
theta 1	0°	—	—	0°	—	—
theta 2	5°	—	16°	5°	—	16°
theta 3	0°	—	7°	0°	—	7°
N	—	160	—	—	160	—



EXAR CORPORATION

160 PIN MQFP PACKAGE OUTLINE

Packaging Approval: Drawing No: 160-PIN MQFP

By: PC Date: 02/11/09 Revision: A Sheet: 1 OF 1